

Presentation to Transportation, Infrastructure and
Capitals Appropriations Subcommittee
January 29, 2003
Department of General Services
Patrick J. Deluhery, Interim Director

General Services provides assistance in maintaining more than 10.9 million square feet of buildings across the state.

The Vertical Infrastructure Program Monitors and
Prioritizes Building Repair Needs Statewide

Major Maintenance Funding--\$15.75 million in
FY2003

Major Maintenance Projects are underway Statewide

Americans with Disabilities Act (ADA) Projects are Funded
with Major Maintenance Appropriations

An Assessment of Monuments has been completed

Routine Maintenance funding from the Rebuild Iowa
Infrastructure Fund was suspended in FY2003

Capitol Building restoration began in 1983.

Interior Work has cost \$21.15 million to Date

Tunnel to Ola Babcock Miller Building

Exterior Work has cost \$40.46 million to Date

Other Capitol Complex Renovation Projects Continue

Lucas Building Renovation is nearing completion--
\$17.33 million

Ola Babcock Miller Building Restoration is nearing
completion--\$21.35 million

Presentation to Transportation, Infrastructure and
Capitals Appropriations Subcommittee
January 29, 2003
Department of General Services
Patrick J. Deluhery, Interim Director

The new Capitol Complex Parking Structure is located at the corner of Penn and Grand--\$12.72 million

Beneficial occupancy is scheduled for February 14, 2003.

Installation of elevators is scheduled for later in the Spring.

It will provide 890 Parking Spaces.

The State's New Laboratories Facility is Under Construction In Ankeny--\$51.18 million

Micrographics Building is scheduled for demolition--\$170,000

Lot 8 / West Capitol Terrace Design is underway--\$93,000 to date, \$1.4 million total cost

Records and Property Building renovation has been funded at \$1.6 million to date, with total cost at \$12.367 million

Future Work on Capitol Complex

Wallace Building Renovation cost is estimated at \$31.723 million total cost

Court Avenue Bridge replacement estimated to cost \$1.2 million

Grimes Building Renovation estimated to cost \$16.1 million in FY2007

Other Capitol Complex Needs

Capitol Complex Paving Repair Needs--\$5 million in FY2005

Capitol Complex Property Acquisition--\$350,000 per year

Iowa State Capitol

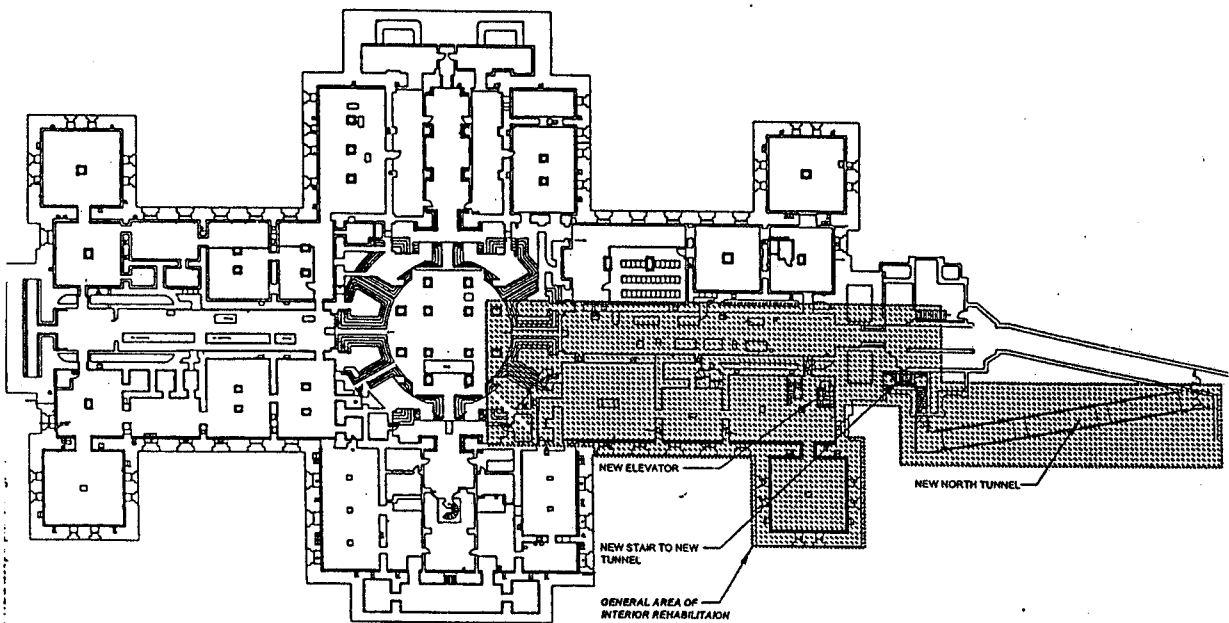
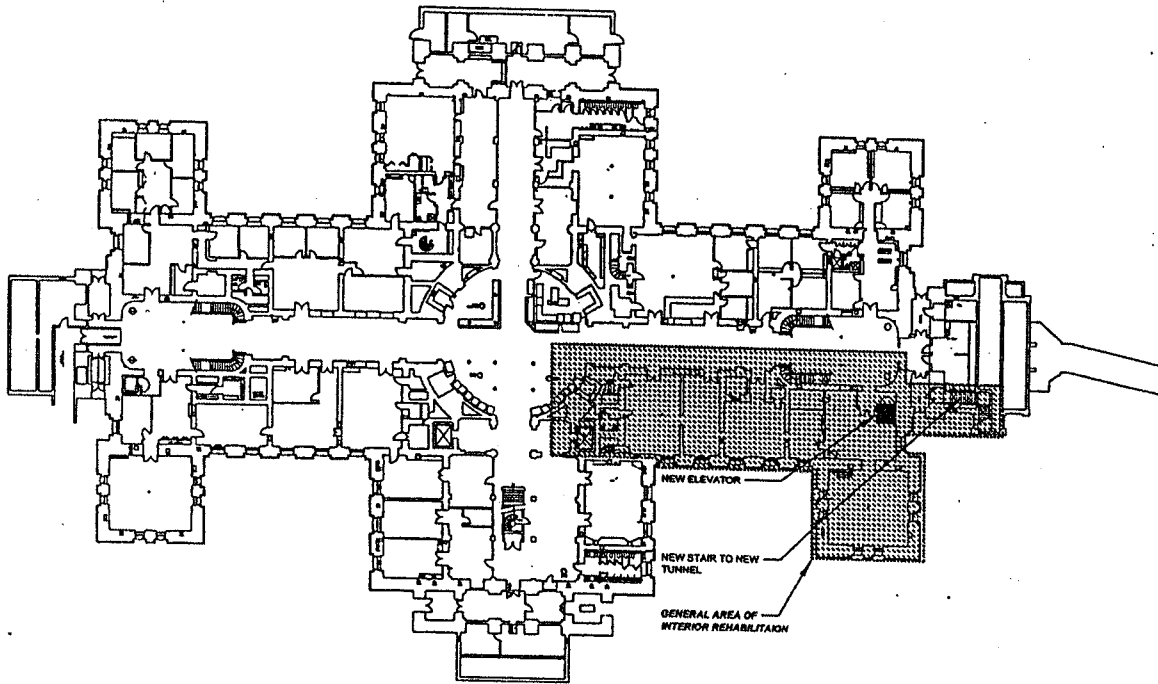

Iowa Laboratories Facility

Ankeny

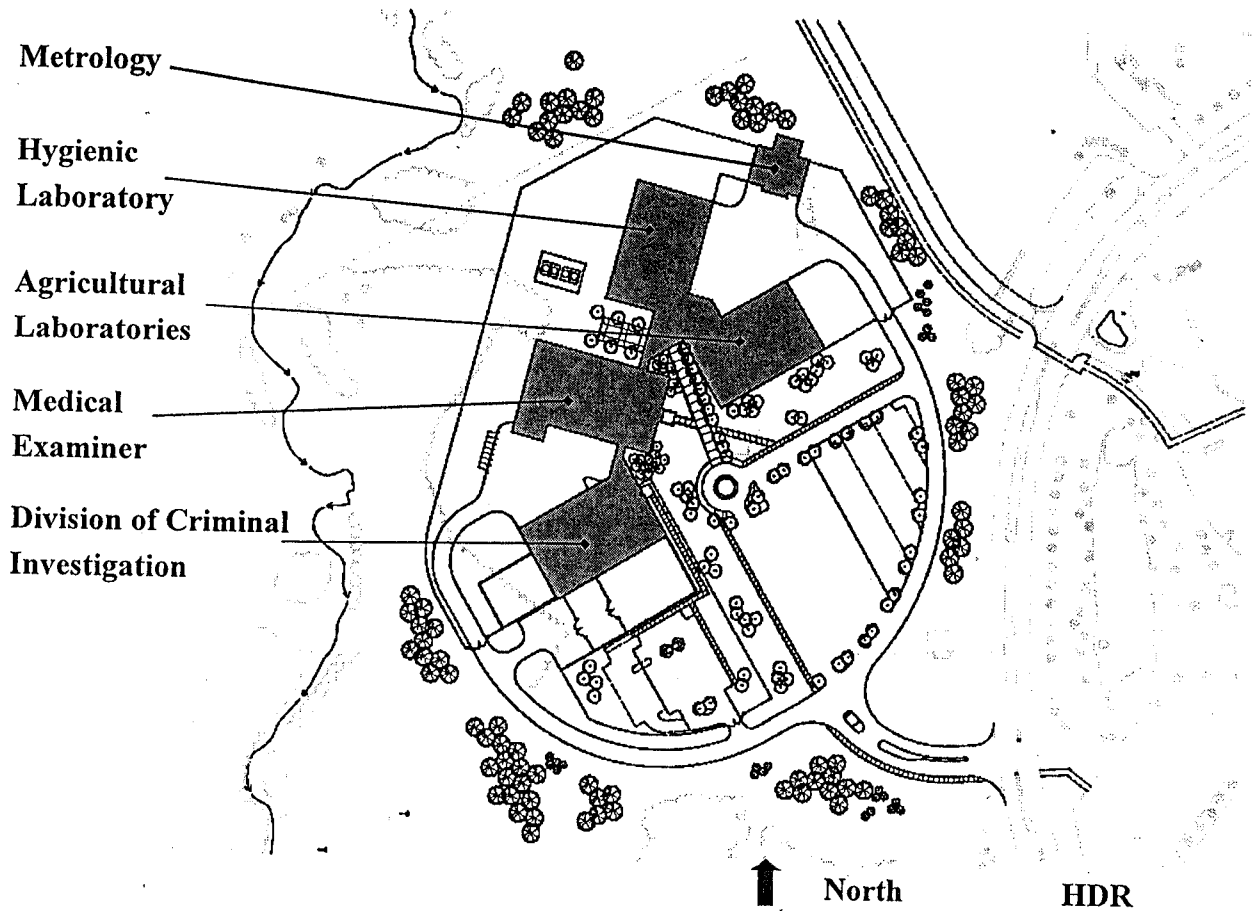

Iowa Dept. of General Services
January 29, 2003

**Capital Projects Recommended by the Vertical Infrastructure Advisory Committee
for FY2004 and FY2005**

1) Statewide Major Maintenance

FY2004: \$16,703,000

FY2005: \$17,535,000

The annual major maintenance appropriation is critical to the success of our top priority—health, life safety and emergency repairs.

2) Statewide Routine Maintenance

FY2004: \$19,180,000

FY2005: \$17,535,000

Routine maintenance funding must be restored if we are to maintain our assets in a safe and functional condition.

3) Statewide Electrical Distribution Repairs

FY2004: \$1,867,000

FY2005: \$17,598,000

Electrical distribution repairs are required at sites and institutions across the state to protect the health, life and safety of our workers and our clients and to prevent facility shut downs.

4) Special Needs Unit, IMCC, Oakdale

FY2004: \$7,500,000

FY2005: \$11,700,000

The Special Needs Unit at the Iowa Medical and Classification Center, along with the associated new power plant, is necessary for the safety of workers and inmates alike.

**5) Routine Maintenance,
Judicial Building, Des Moines**

FY2004: \$273,000

FY2005: \$281,000

Routine maintenance needs for the new Judicial Building will begin in FY2004 and will continue throughout its life.

**6) Routine Maintenance,
Laboratories Building, Ankeny**

FY2004: \$0

FY2005: \$157,000

Routine maintenance needs for the new Labs Building under construction in Ankeny will begin in FY2005.

7) Dietary Renovation, ASP, Anamosa

FY2004: \$3,250,000

FY2005: \$0

The need to renovate the food service facility at the Anamosa State Penitentiary remains on our list of critical projects.

**Capital Projects Recommended by the Vertical Infrastructure Advisory Committee
for FY2004 and FY2005**

- 8) Relocation and Transition Costs,
Capitol Complex and Des Moines Area
- | | |
|---------------|-------------|
| FY2004: | \$1,711,901 |
| FY2005: | \$4,935,218 |

Relocation and transition costs are critical to the accomplishment of facility improvements on the Capitol Complex.

- 9) Elevator and Stair Addition, CCUSO, Cherokee
- | | |
|---------------|-----------|
| FY2004: | \$750,000 |
| FY2005: | \$0 |

New stair and elevator additions for the civil commitment unit for sexual offenders currently being developed in Cherokee are critical improvements to provide for safe operation of this facility.

- 10) Renovate Additional Wards, CCUSO, Cherokee
- | | |
|---------------|-------------|
| FY2004: | \$1,167,700 |
| FY2005: | \$0 |

The renovation of two additional wards for the civil commitment unit at Cherokee will allow for projected expansion of bed space.

- 11) Records and Property Building Renovation and
Addition, Capitol Complex, Des Moines
- | | |
|---------------|--------------|
| FY2004 | \$10,767,000 |
| FY2005: | \$0 |

Funds have been appropriated to begin planning for the renovation of the Records and Property Building on the Capitol Complex and this request will allow for the work to proceed.

- 12) Wallace Building Evaluation and Recommendations
Capitol Complex, Des Moines
- | | |
|---------------|-----------|
| FY2004 | \$250,000 |
| FY2005: | \$0 |

General Services has requested funding for both an evaluation of the building's repair needs and for the renovation work.

- 13) Replacement Facility, State Patrol District 8,
Mason City
- | | |
|---------------|-------------|
| FY2004: | \$1,700,000 |
| FY2005: | \$0 |

This replacement facility will meet new and emerging requirements of the state patrol in serving the needs of Iowans.